

Chesapeake drilling in Brooke County

Chesapeake pools properties in West Virginia into “units” and is currently drilling in these ten. Units typically slant southeast to northwest so drillers can drill in a straight line and fracture shale rock at an angle that allows more gas to escape. The units contain several adjoining properties and can stretch up to 1,280 acres.



BARRY
GREATHOUSE B



BROOKE COUNTY
PARKS NORTH

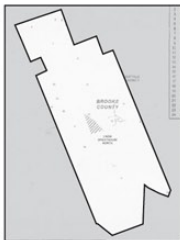

LINDA GREATHOUSE
NORTH



NICK BALLATO
NORTH



BROOKE/BUFFALO
DISTRICT



MARK OWEN
SOUTH



MARK OWEN
NORTH



OV ROYALTY TRUST
LLC NORTH

MORTGAGED PROPERTIES

Chesapeake CEO Aubrey McClendon has mortgaged personal stakes in two Brooke County units that appear less conducive to horizontal drilling.

These units are not as easily shaped as others in the county, either because there is unleased property in the middle or because surrounding firms have forced a jagged border.



JOHN HUPP NORTH



MILDRED MANI